

BABY KING COBRA

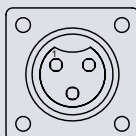

Miniature, Economical & Rugged Circular Connector Systems

Connector Versions



BKC320:
Three (3) Size 20
Contacts

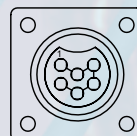

BKC620:
Six (6) Size 20
Contacts

Technical Characteristics

Materials and Finishes

Insulator: Glass-filled nylon, UL 94V-0.

Contacts: Precision machined copper alloy with gold over nickel plate.

'O' Ring: Silicon, UL 94V-0

Electrical Characteristics

Contact Current Ratings

Size 20 Contacts: 7.5 amperes nominal.

Initial Contact Resistance per IEC 512-2, Test 2b.

Size 20 Contacts: 0.005 ohms, maximum.

Insulator Resistance per IEC 512-2, Test 3a.

Insulator: 5 G ohms, minimum.

Proof Voltage

Size 20 Contacts: 1000 V r.m.s.

Working Voltage

Size 20 Contacts: 250 V r.m.s.

Climatic Characteristics

Working temperature: -55°C to +125°C

Dust and

Water Ingress: IP65 with overmolded Assemblies (Consult Factory for details)

Mechanical Characteristics

Polarization: Provided by insulator.

Fixed Contacts: Size 20 female contacts feature "Open Entry" 500 cycles design.

Contact Retention
in Insulator:

Size 20 Contacts: 27 N [6 lbs.] minimum.

Locking System:

Threaded or Twist
Locking Shroud

UL :

File E220614



POSITRONIC
GLOBAL *Connector* SOLUTIONS

www.connectpositronic.com



THREADED LOCKING SYSTEM

Male Connector

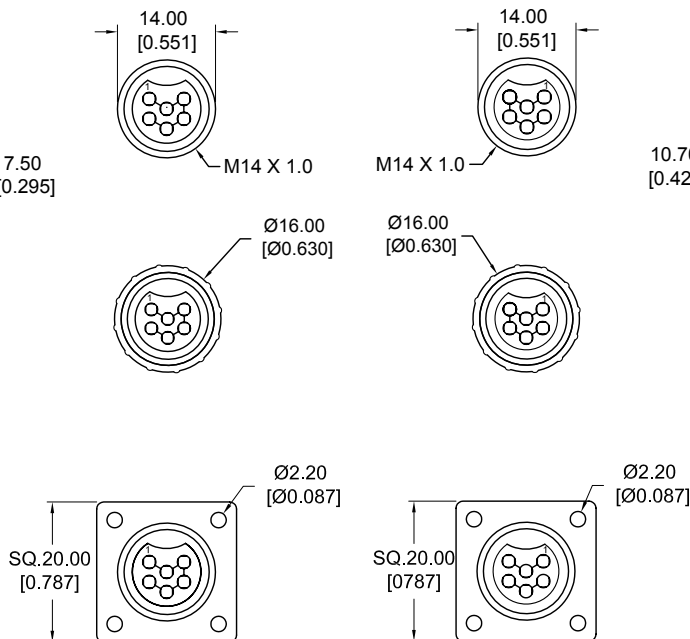
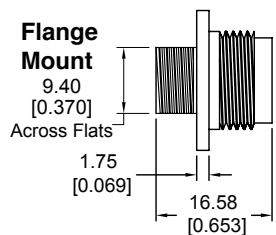
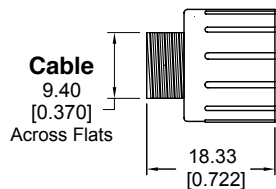
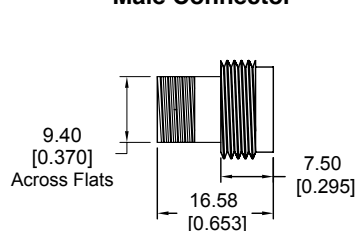

Female Connector

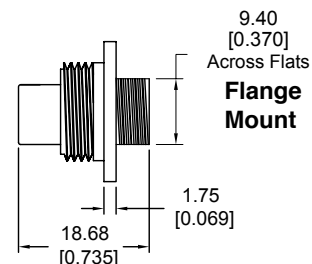
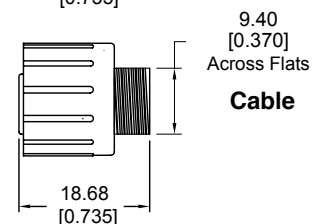
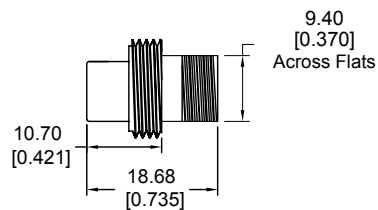

TWIST LOCKING SYSTEM

Male Connector

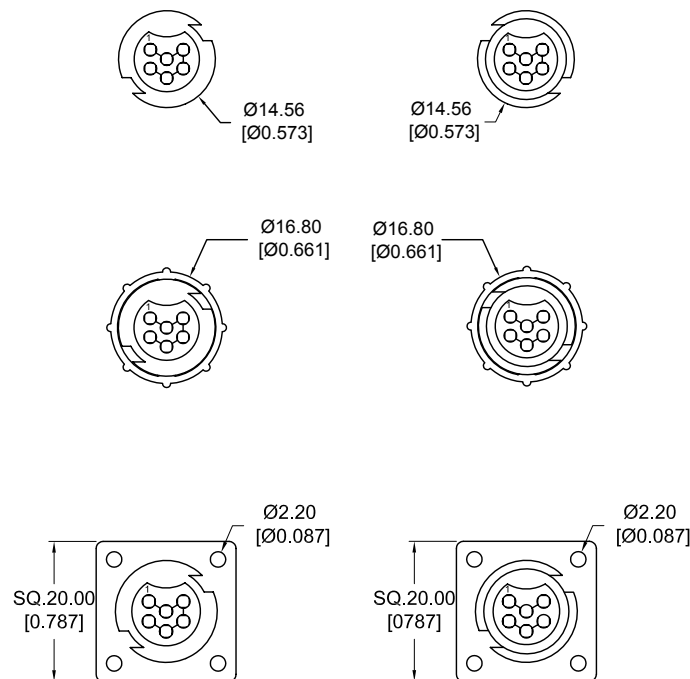
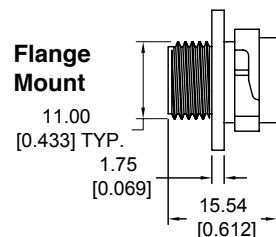
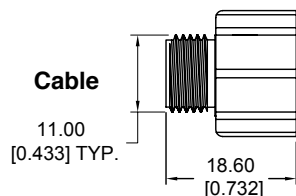
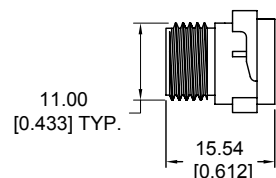

Female Connector

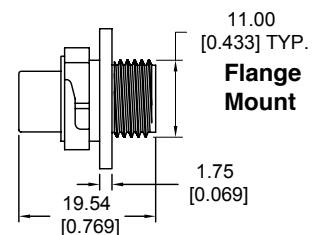
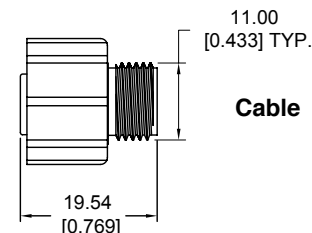
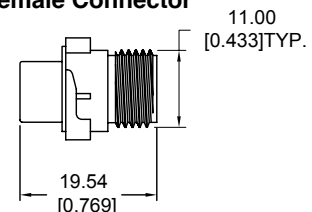

Above Dimensions are same for both BKC320 and BKC620 versions.

Solder Cup Contacts / Accessories



**BABY KING
COBRA**
Circular Connectors

Solder Cup Contacts

Male Connector

Typical Part Number:
BKC620M2T10

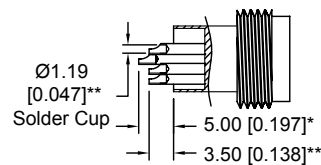

Typical Part Number:
BKC620M2TW10

Specify code M2TW
in Step 2

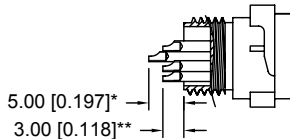

Ø1.19
[0.047]**
Solder Cup

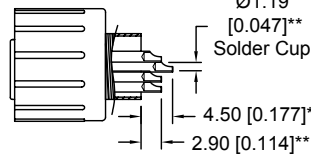

Female Connector

Typical Part Number:
BKC620F2T20

Typical Part Number:
BKC620F2TW30

Specify code F2TW in
Step 2

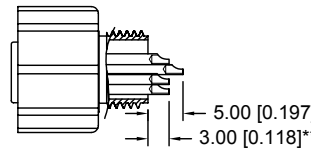

* applicable for BKC620 only.
** applicable for BKC620 and BKC320.

ACCESSORIES

Connector with Hood Male or Female

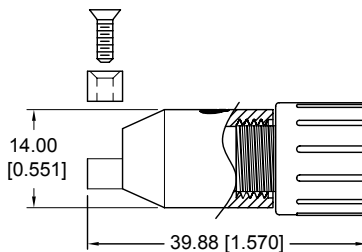

Materials:

Hood & Clamp: Nylon, UL 94V-0.
Screws: Steel with zinc plate.

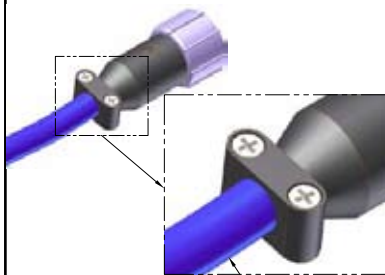

Note: Hood design can accommodate
jacketed cable Ø between 4.50mm
[0.177] to 6.00mm [0.236]

Panel Mounting Option

Rear Panel Mount

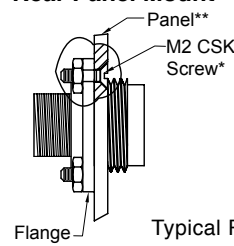

Typical Part Number:
BKC320M2T1FT
BKC620M2T1PF

Front Panel Mount

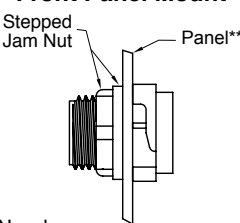

Typical Part Number:
BKC320M2TW1P
BKC620M2TW1P

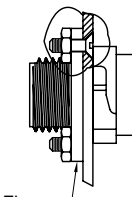

Typical Part Number:
BKC320M2TW1PF
BKC620M2TW1PF

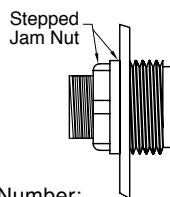

Typical Part Number:
BKC320M2T1P
BKC620M2T1P

Materials:

Screws and Nuts: Steel with zinc plate.

*Screw and nut shown for reference only.

**Panel thickness 1.50 [0.059] max only.

Panel Cutout

Front Mount (Jam Nut)

Twist Lock Cutout

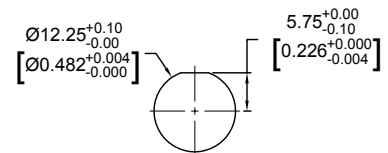

Threaded Lock Cutout

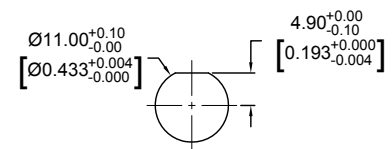

Rear Mount Cutout for Threaded Lock or Twist Lock Connector with Flange

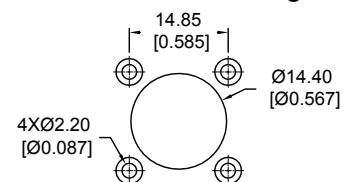

Dust Cover

Panel Mount



Cable

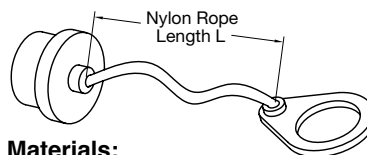

Materials:

Dust Cover: Glass-Filled Nylon, UL 94V-0.

Ordering Part Numbers:
(Female Dust Cover Part Number)

5132-19-1 L=100[3.937]

5132-19-2 L=35[1.378]

For Male Dust Cover, please consult factory.
The above part numbers to be ordered separately.

Unless otherwise specified, dimensional tolerances are:

- 1) Male contact mating diameters : ± 0.03 [0.001]
- 2) Contact termination diameters : ± 0.08 [0.003]
- 3) All other diameters : ± 0.13 [0.005]
- 4) All other dimensions : ± 0.38 [0.015]

Dimensions are in millimeters [inches].
All dimensions are subject to change.

**For Overmolded
BKC Series Cable Assemblies.
Please Contact Sales.**





TYPICAL CONNECTOR ASSEMBLY & ORDERING INFORMATION



Typical Connector Assembly Threaded Locking System

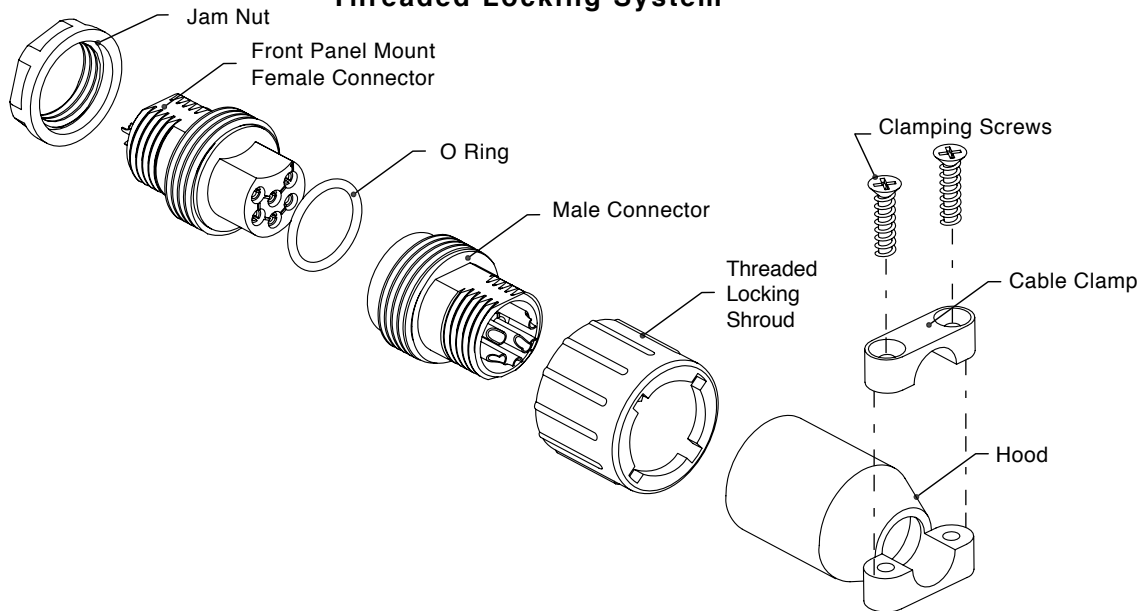

Connector Ordering Information

Specify complete connector by following step 1 through step 5.

Step	1	2	3	4	5
Example	BKC620	F2T1	PF	/AA	- XXX

STEP 1: CONNECTOR VERSION

Baby King Cobra Series -
BKC620 : Six (6) size 20 contacts.
BKC320 : Three (3) size 20 contacts.

STEP 2: CONNECTOR GENDER AND TYPE OF CONTACTS

M2T1 : Threaded Male, solder cup, fixed contacts.
(Supplied Without Threaded Locking Shroud)
F2T1 : Threaded Female, solder cup, fixed contacts.
(Supplied Without Threaded Locking Shroud)
M2T2 : Threaded Male, solder cup, fixed contacts.
(Supplied With Threaded Locking Shroud)
F2T2 : Threaded Female, solder cup, fixed contacts.
(Supplied With Threaded Locking Shroud)
(M2T1 mates only with F2T2 or F2T1.)
(F2T1 mates only with M2T2 or M2T1.)

M2TW1 : Twist Male, solder cup, fixed contacts.
(Supplied without Twist Locking Shroud)
F2TW1 : Twist Female, solder cup, fixed contacts
(Supplied without Twist Locking Shroud)
M2TW3 : Twist Male, solder cup, fixed contacts.
(Supplied with Twist Locking Shroud)
F2TW3 : Twist Female, solder cup, fixed contacts.
(Supplied with Twist Locking Shroud)
(M2TW1 mates only with F2TW3 or F2TW1.)
(F2TW1 mates only with M2TW3 or M2TW1.)

STEP 6 - SPECIAL OPTIONS

Consult factory for special options.

STEP 4: ENVIRONMENTAL COMPLIANCE OPTION

/AA : Compliance per EU Directive 2002/95/EC (RoHS)
Example: BKC620M2T2P/AA.
Note : If RoHS legislation is not required, this step will not be used.
Example: BKC620M2T2P.

STEP 3: MOUNTING STYLES AND HOOD

0 : None.
P : Panel mount with jam nut and without flange.
(Available in Front Mount version only)
PF : Panel mount with Flange and without jam nut.
(Available in Rear Mount version only)
J : Hood.

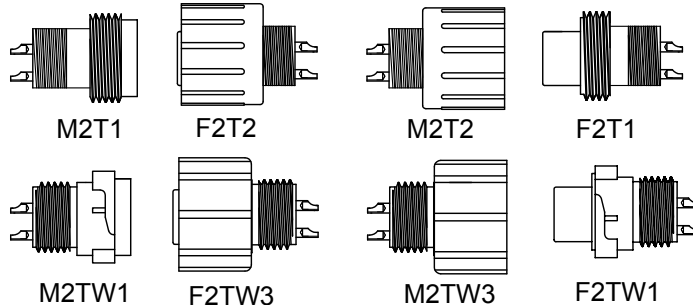

Above views applicable for both BKC620 and BKC320 versions.

Positronic believes the data contained herein to be reliable. Since the technical information is given free of charge, the user employs such information at his own discretion and risk. Positronic assumes no responsibility for results obtained or damages incurred from use of such information in whole or in part.

POSITRONIC INDUSTRIES, INC.

423 N Campbell Ave, PO Box 8247
Springfield, MO 65801, USA
Telephone (417) 866-2322
Fax (417) 866-4115
Toll Free (800) 641-4054
info@connectpositronic.com

POSITRONIC INDUSTRIES, S.A.S.

Zone Industrielle d'Engachies
46 Route d'Engachies
France 32020 Auch Cedex 9
Telephone 33 (0) 5 6263 4491
Fax 33 (0) 5 6263 5117
contact@connectpositronic.com

POSITRONIC ASIA PTE LTD.

Blk 3014A
Ubi Road 1 #07-01
Singapore 408703
Telephone 65 6842 1419
Fax 65 6842 1421
singapore@connectpositronic.com

KING COBRA

Rugged & Economical Circular Connector Systems

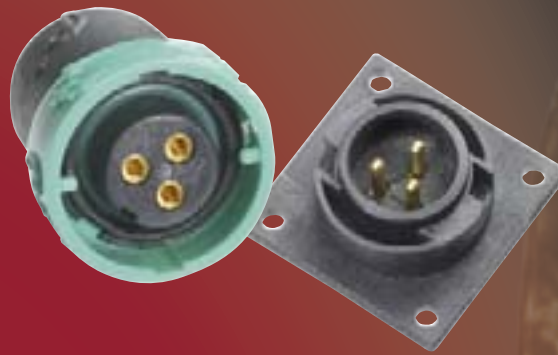

PROFESSIONAL-QUALITY IP65 - RATED CIRCULAR CONNECTORS



- IP65 Environmental Rating
- Cable, Panel And PC Mount Options
- Solid Machined Contacts
- Unique "Twist-Lock" Mechanism

Positronic Industries
www.connectpositronic.com

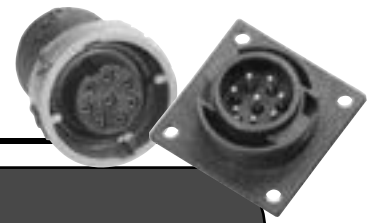

FEATURES:

- Circular “Twist-Lock” connectors with competitive pricing!
- Dust and water ingress protection to IP65 per IEC 60529.
- High reliability power and signal solid machined contacts.
- High mating cycle life and vibration-resistant capabilities!

Typical Connector Assembly

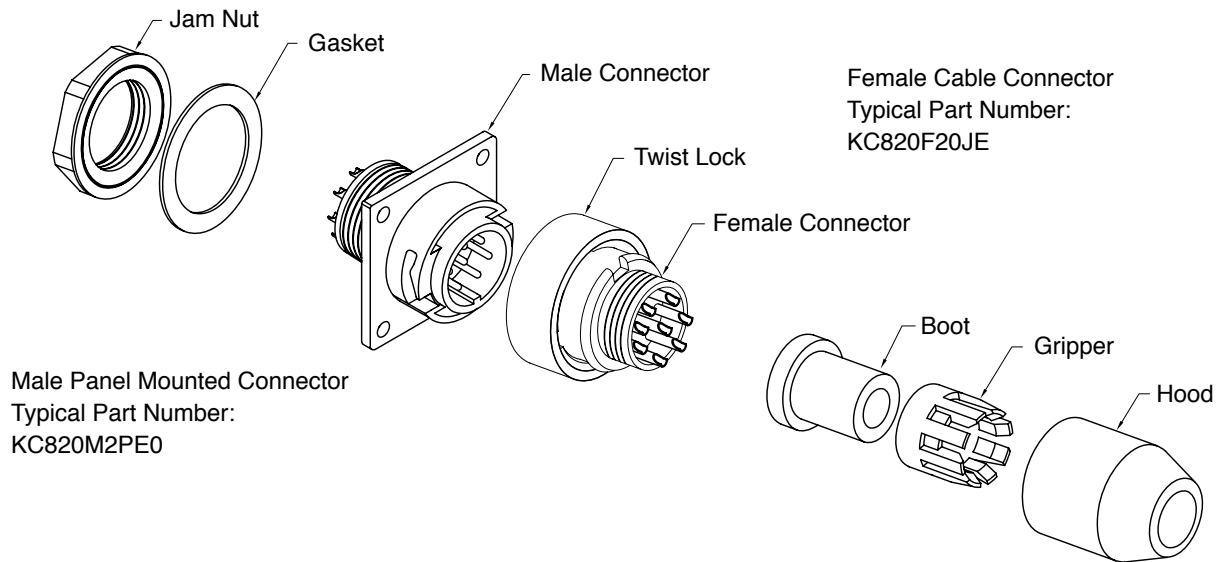

Connector Versions

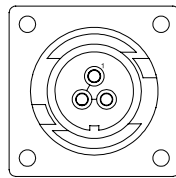

KC316:
Three (3) Size 16
Power Contacts

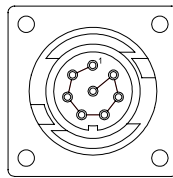

KC820:
Eight (8) Size 20
Signal Contacts

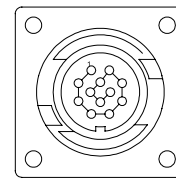

KC1222:
Twelve (12) Size 22
Removable Signal Contacts

Unless otherwise specified, dimensional tolerances are:

- | | |
|----------------------------------|----------------------|
| 1) Male contact mating diameters | : ± 0.03 [0.001] |
| 2) Contact termination diameters | : ± 0.08 [0.003] |
| 3) All other diameters | : ± 0.13 [0.005] |
| 4) All other dimensions | : ± 0.38 [0.015] |

Dimensions are in millimeters [inches]. All dimensions are subject to change.

Catalog A-004 rev. NC

Positronic believes the data contained herein to be reliable. Since the technical information is given free of charge, the user employs such information at his own discretion and risk. Positronic assumes no responsibility for results obtained or damages incurred from use of such information in whole or in part.



Positronic Industries, Inc
www.connectpositronic.com
www.positronicasia.com

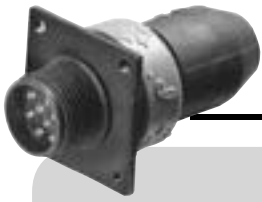

TECHNICAL INFORMATION

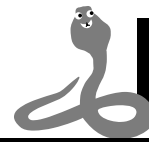

KING COBRA
Circular Connectors

Technical Characteristics

Materials and Finishes

Insulator:	Glass-filled nylon, UL 94V-0.
Contacts:	Precision machined copper alloy with gold over nickel plate.

Electrical Characteristics

Contact Current Ratings

Size 16 Contacts:	20.0 amperes.
Size 20 Contacts:	7.5 amperes.
Size 22 Contacts:	3.0 amperes.

Initial Contact Resistance per IEC 512-2, Test 2b.

Size 16 Contacts:	0.003 ohms, maximum.
Size 20/22 Contacts:	0.005 ohms, maximum.

Insulator Resistance per IEC 512-2, Test 3a.

Insulator:	5 G ohms, minimum.
------------	--------------------

Proof Voltage

Size 16 Contacts:	1300 V r.m.s.
Size 20/22 Contacts:	1000 V r.m.s.

Working Voltage

Size 16 Contacts:	433 V r.m.s.
Size 20/22 Contacts:	333 V r.m.s.

Climatic Characteristics

Working temperature:	-55°C to +125°C
----------------------	-----------------

Dust and Water Ingress Protection:	IP65 per IEC 60529 in mated condition (when jacketed cable is used). Degree of protection is dust-tight (no ingress of dust) and protected against water projected in jets from any direction.
------------------------------------	--

Mechanical Characteristics

Polarization:	Provided in insulator design.
Removable Contacts:	Insert contact in rear face of insulator; release from front face of insulator. Size 22 Female contacts feature "Open Entry" 500 cycles design and "Closed Entry" 1000 cycles minimum design options.
Fixed Contacts:	Size 16 female contacts feature "Closed Entry" 1000 cycles minimum design. (Consult factory for higher cycle options.) Size 20 female contacts feature "Open Entry" 500 cycles design. (Consult factory for "Closed Entry" options.)

Contact Retention in Insulator:

Size 16 Contacts:	45 N [10 lbs.] minimum.
Size 20/22 Contacts:	27 N [6 lbs.] minimum.

Coupling System:	Twist lock.
------------------	-------------

Shock and Vibration:	Pending. (Consult factory)
----------------------	-------------------------------

Recognized

UL certification in process.
Consult factory for TÜV recognition.

Temperature Rise Curve and Contact Performance

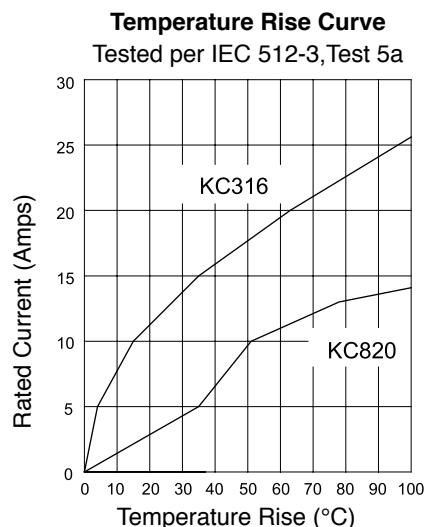

Above curves developed separately using (a) KC316 connectors and 16 AWG wires, and (b) KC820 connectors and 20 AWG wires. All contacts under load.

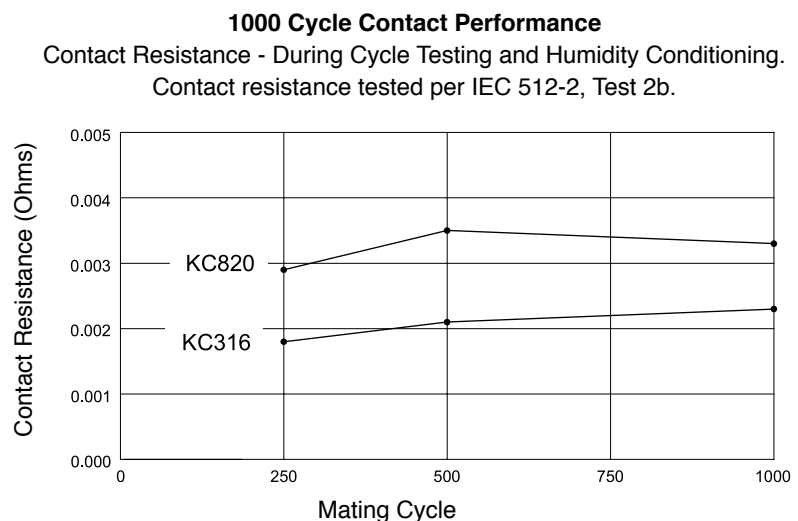

Humidity conditioning per EIA-364-31B, Method II (Condition A) after 250, 500 and 1000 mating cycles. Above curves developed separately using (a) KC316 connectors, and (b) KC820 connectors.





Outline Dimensions

Male Connector

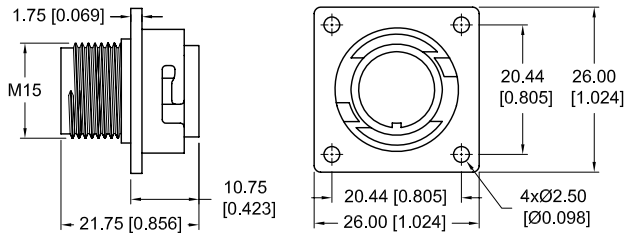

Female Connector

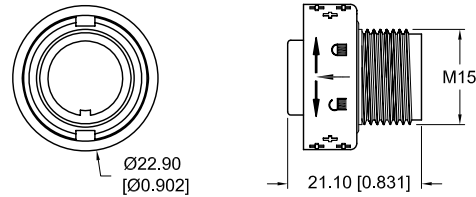

Solder Cup Contacts

Available in versions KC316 and KC820 only

Male Connector Typical Part Number: KC820M200

Specify code M2 in Step 2

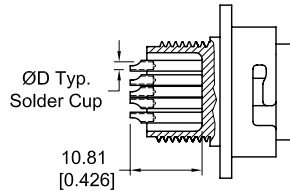

Version	ØD
KC316	1.40 mm [0.055 inch]
KC820	1.19 mm [0.047 inch]

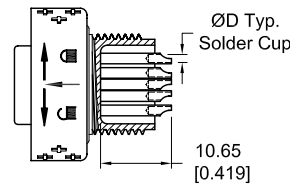

Female Connector Typical Part Number: KC820F200

Specify code F2 in Step 2

PCB Mount Contact Dimensions and PCB Hole Patterns

Straight and Right Angle (90°) PCB Mount Male Connectors

Straight PCB Mount

(Available in male connectors only)
Specify code M3 in Step 2

Version 316

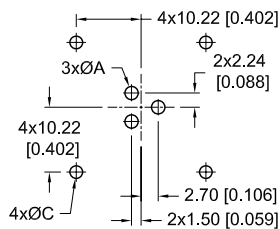
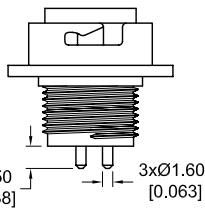

Version 820

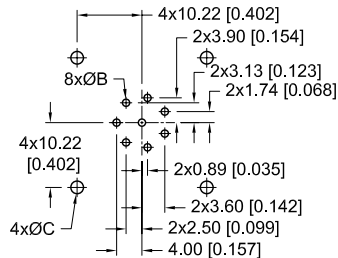
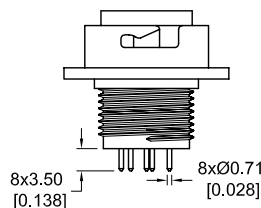

Right Angle (90°) PCB Mount

(Available in male connectors only)
Specify code M4 in Step 2

Version 316

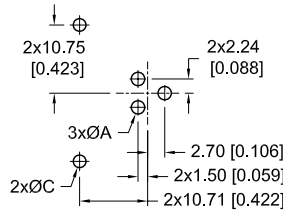
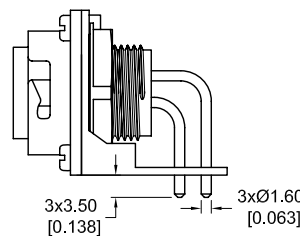

Version 820

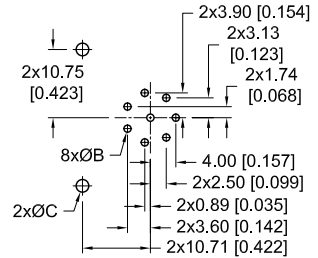
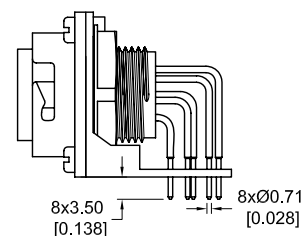

Note: Contact factory for availability of Female PCB Mount versions.

Suggested PCB Hole Sizes and Mounting Screw:

Suggested ØA = Ø2.03 [0.080] holes for size 16 contact termination holes. (Version 316).

Suggested ØB = Ø1.14 [0.045] holes for size 20 contact termination holes. (Version 820).

Suggested ØC = Ø2.00±0.08 [0.079±0.003] holes for use with push-on fasteners.

Suggested ØC = Ø2.54 [0.100] holes for mounting connector with screws. Screws ordered separately. Screw part number 4546-7-1-16 for PCB thickness between 1.00 mm [0.039 inch] and 2.50 mm [0.098 inch]. (Consult factory for other PCB thickness requirements.)



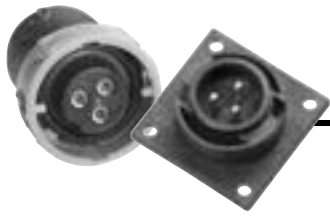

PANEL MOUNT CONNECTORS, ACCESSORIES AND SCREW TERMINATION VERSION

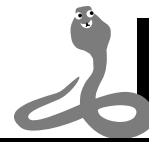

KING COBRA
Circular Connectors

Panel Mounting Options

Available in male connectors only

Front Panel Mount Typical Part Number: KC316M2P0

Specify code P in Step 3

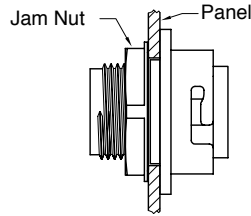

Panel Cutout for Front Panel Mount

Maximum thickness 2.00 mm
[0.079 inch]

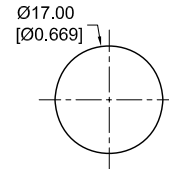

Rear Panel Mount Typical Part Number: KC820M2PR0

Screws, nuts and washers
supplied seperately.

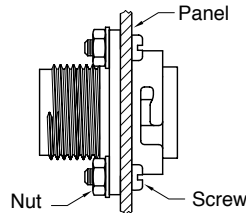

Panel Cutout for Rear Panel Mount

Maximum thickness 2.00 mm
[0.079 inch]

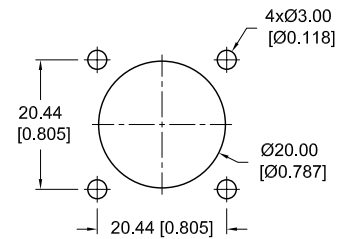

(Screws and nuts shown for reference only)

Accessories

Jam Nut

Supplied factory installed to
connector.

(See ordering information
- code P in step 3)

Material:

Jam nut: Nylon, UL 94V-0.

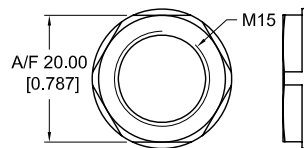

Spacers

Supplied factory installed to
connector with 4 screws.

Specify code S in step 3

Materials and Finish:

Spacer: Nylon, UL 94V-0.

Screw: Steel with zinc plate

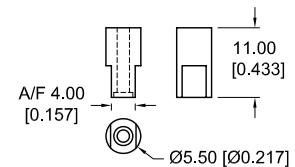

Alignment Bar

Supplied factory installed on
all right angle (90°) PCB mount
connectors with 4 screws.

Materials and Finish:

Alignment Bar: Nylon, UL 94V-0.

Screw: Steel with zinc plate.

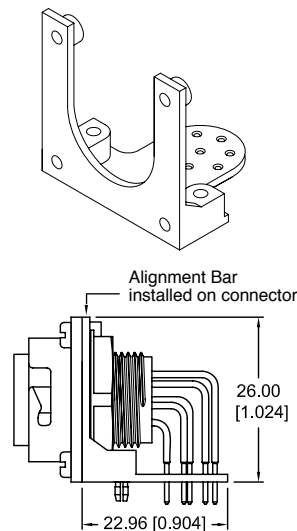

See page 3 for
mounting hole details.

Spacers with Push-on Fasteners

Supplied factory installed to connector.

Specify code S6 in step 3

Materials and Finishes:

Push-on Fastener:

Copper alloy with tin plate.

Spacer: Nylon, UL 94V-0.

Screw: Steel with zinc plate.

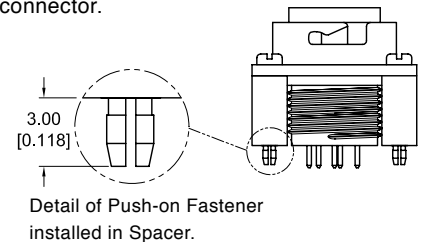

Detail of Push-on Fastener
installed in Spacer.

Dust Cover

Consult factory for availability.

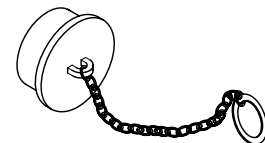

Screw Termination Connector

Typical Part Number: KC316F700

Specify code F7 in Step 2.

Available in version KC316 female connector only.

Materials and Finish:

Terminal and Screw:

Copper alloy with tin plate

Plastic Shroud: Nylon, UL 94V-0.

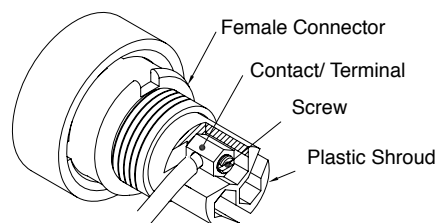

Note:

Screw Termination accomodates
maximum wire size AWG 18 [1.0 mm²].





Detail of IP65 Version Connectors and Hood

Male Front Panel Mount Connector

Typical Part Number: KC820M2PE0

(Consult factory for rear panel mount IP65 applications.)

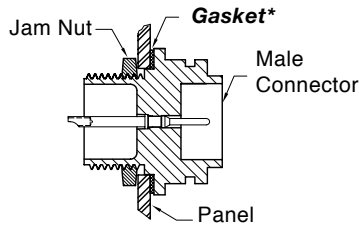

Female Cable Connector

Typical Part Number: KC316F20JE

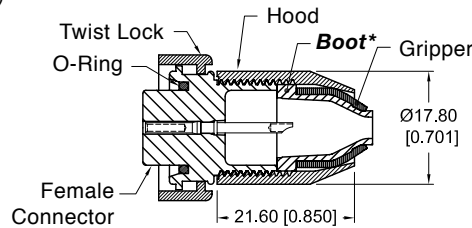

Materials:

Hood and Gripper: Nylon, UL 94V-0.
Boot and Gasket: Nitrile.
O-Ring: Silicon.

Note:

Hood design can accommodate jacketed cable diameters between 4.00mm [0.157 inch] and 7.00mm [0.276 inch].

** For IP65 version only*

Detail of Non-IP65 Version Connectors and Hood

Male Front Panel Mount Connector

Typical Part Number: KC316M2P0

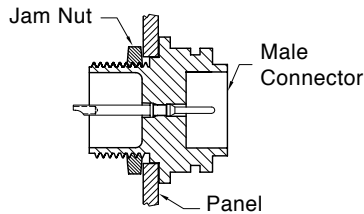

Female Cable Connector

Typical Part Number: KC820F20J

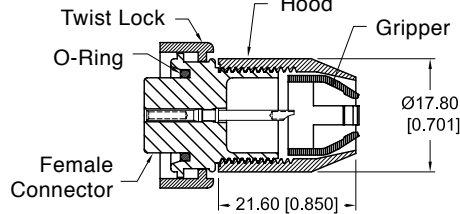

Materials:

Hood and Gripper: Nylon, UL 94V-0.
O-Ring: Silicon.

Note:

Hood design can accommodate jacketed cable diameters between 4.00mm [0.157 inch] and 7.00mm [0.276 inch].

Removable Crimp Contacts for Version KC1222

MC422N

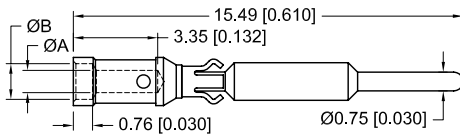

FC422N4 (Open Entry)

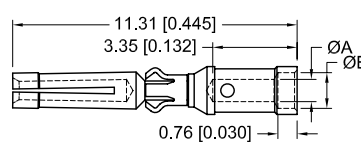

FC422N2 (Closed Entry)

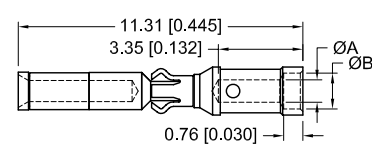

Male Contact	Female Contact	Wire Size AWG [mm²]	ØA	ØB
MC422N	FC422N4 FC422N2	22 [0.3] - 24 [0.25]	0.89 [0.035]	1.42 [0.056]

Please use correct wire size and it should be smaller than ØA of the contact
(Consult factory for solder style removable contacts.)

Recommended Tools for Crimp Contacts

Contact Extraction Tool
Shown for reference only



Contact Insertion Tool
Shown for reference only



Cycle-Controlled Step
Adjustable Hand Crimp Tool
Shown for reference only



Contact Size	Contact Extraction Tool	Contact Insertion Tool	Hand Crimp Tool	Semi-Automatic Crimp Machine
Size 22	9081-3	9099-1	9507-0 with 9502-12 positioner (male contacts) 9507-0 with 9502-23 positioner (female contacts)	9550-1



Ordering Information - Code Numbering System

Specify complete connector by following step 1 through step 4

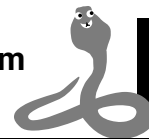

KING COBRA
Circular Connectors

Step	1	2	3	4	5		6	King Cobra Version 316
Example	KC316	M2	PE	JE	/AA	-	XXX	
STEP 1: CONNECTOR VERSION KC316 : King Cobra Series - Three (3) Size 16 Contacts						STEP 6 - SPECIAL OPTIONS Consult factory.		
STEP 2: CONNECTOR GENDER AND TYPE OF CONTACTS M2 : Male panel mount, solder cup, fixed contacts. M3 : Male straight PCB mount, solder. M4 : Male right angle (90°) PCB mount, solder. F2 : Female cable connector, solder cup, fixed contacts. (Select 0 in Step 3) F7 : Female cable connector, screw termination. Supplied with contacts. (Select 0 in Step 3) Note : Consult factory for other connector versions.						STEP 5: RoHS COMPLIANCE OPTIONS /AA : Compliance per EU Directive 2002/95/EC (RoHS) Note : If RoHS legislation is not required, this step will not be used.		
						STEP 4: HOODS 0 : None. J : Hood with gripper, non-IP65. JE : Hood with gripper and boot, IP65.		
		STEP 3: MOUNTING STYLES 0 : None. S : Spacer for straight PCB mount connectors. S6 : Spacer with push-on fastener for straight PCB mount connectors. N : Push-on fastener for use with alignment bar and right angle (90°) PCB mount connectors. P : Front panel mount male connectors with jam nut, non-IP65. PE : Front panel mount male connectors with jam nut and gasket, IP65. PR : Rear panel mount male connectors, non-IP65. PRE : Rear panel mount male connectors with gasket, IP65.						

Step	1	2	3	4	5		6	King Cobra Version 820
Example	KC820	F2	0	JE	/AA	-	XXX	
STEP 1: CONNECTOR VERSION KC820 : King Cobra Series - Eight (8) Size 20 Contacts						STEP 6 - SPECIAL OPTIONS Consult factory.		
STEP 2: CONNECTOR GENDER AND TYPE OF CONTACTS M2 : Male panel mount, solder cup, fixed contacts. M3 : Male straight PCB mount, solder. M4 : Male right angle (90°) PCB mount, solder. F2 : Female cable connector, solder cup, fixed contacts. (Select 0 in Step 3)						STEP 5: RoHS COMPLIANCE OPTIONS /AA : Compliance per EU Directive 2002/95/EC (RoHS) Note : If RoHS legislation is not required, this step will not be used.		
						STEP 4: HOODS 0 : None. J : Hood with gripper, non-IP65 JE : Hood with gripper and boot, IP65.		
		STEP 3: MOUNTING STYLES 0 : None. S : Spacer for straight PCB mount connectors. S6 : Spacer with push-on fastener for straight PCB mount connectors. N : Push-on fastener for use with alignment bar and right angle (90°) PCB mount connectors. P : Front panel mount male connectors with jam nut, non-IP65. PE : Front panel mount male connectors with jam nut and gasket, IP65. PR : Rear panel mount male connectors, non-IP65. PRE : Rear panel mount male connectors with gasket, IP65.						

Step	1	2	3	4	5	6		King Cobra Version 1222
Example	KC1222	M1	P	J	/AA	-	XXX	
STEP 1: CONNECTOR VERSION KC1222 : King Cobra Series - Twelve (12) Size 22 Contacts					STEP 6 - SPECIAL OPTIONS Consult factory.			
STEP 2: CONNECTOR GENDER AND TYPE OF CONTACTS M1 : Male panel mount, removable crimp contacts. F1 : Female cable connector, removable crimp contacts. (Select 0 in Step 3) Note: Contacts ordered separately.					STEP 5: RoHS COMPLIANCE OPTIONS /AA : Compliance per EU Directive 2002/95/EC (RoHS) Note : If RoHS legislation is not required, this step will not be used.			
					STEP 4: HOODS 0 : None. J : Hood with gripper, non-IP65 JE : Hood with gripper and boot, IP65.			
		STEP 3: MOUNTING STYLES 0 : None. P : Front panel mount male connectors with jam nut, non-IP65. PE : Front panel mount male connectors with jam nut and gasket, IP65. PR : Rear panel mount male connectors, non-IP65. PRE : Rear panel mount male connectors with gasket, IP65.						

ASIA / PACIFIC SALES OFFICES

Singapore Factory, Sales and Engineering Office

Singapore	+65 6842 1419
Japan	+813 5812 7720
South Korea	+82 31 909 8047
India	+91 20 2439 4810
Taiwan	+886 2 2937 8775
China	+86 755 2643 7578
Shanghai	+86 21 5078 2096
Shenzhen	+86 755 2643 7578
Malaysia	+60 4 644 9688
New Zealand	+64 3 358 5154
Australia	+61 2 4362 3293

singapore@connectpositronic.com

japan@connectpositronic.com

korea@connectpositronic.com

india@connectpositronic.com

taiwan@connectpositronic.com

shanghai@connectpositronic.com

shenzhen@connectpositronic.com

newzealand@connectpositronic.com

australia@connectpositronic.com

NORTH AMERICAN SALES OFFICES

United States, Springfield, Missouri

Factory and Sales Office 800 641 4054

Puerto Rico Sales Office 787 841 0920

Mexico Sales Office 800 872 7674

Canada Sales Office 800 327 8272

EUROPEAN SALES OFFICES

France, Auch Factory and Sales 33 (0) 5 6263 4491

Northern France Sales Office 33 (0) 1 4588 1388

Southern France Sales Office 33 (0) 4 6772 8028

Italy Sales Office 39 (0) 2 5411 6106

Germany Sales Office 49 (0) 23 5163 4739

Europe & Middle East Technical Agents:

Austria, Benelux, Denmark, Finland, Greece,

United Kingdom, Ireland, Scotland, Slovenia,

Spain, Sweden, Switzerland, Israel and Turkey

POSITRONIC INDUSTRIES, INC

423 N Campbell Avenue, P O Box 8247,

Springfield, MO 65801, USA

Telephone: 1 417 866 2322

Fax: 1 417 866 4115

Email: info@connectpositronic.com

POSITRONIC INDUSTRIES, SA

Zone Industrielle Est, 46 Route d'Engachies,

F32020, Auch Cedex 9, France

Telephone: 33 05 62 63 44 91

Telecopieur: 33 (0) 5 62 63 51 17

Email: contact@connectpositronic.com

POSITRONIC ASIA PTE LTD

3014A Ubi Road 1 # 07-01 Singapore 408703

Telephone: 65 6842 1419 Fax: 65 6842 1421

Email: singapore@connectpositronic.com

www.connectpositronic.com



KING COBRA
Rugged & Economical Circular Connector Systems



Positronic Industries
www.connectpositronic.com

