

Assembly tools

TCA products	194
Hardmetric products	198
Accessories	204
DIN products	206
Accessories	212
PC/104, PC/104-Plus	214
VarPol connectors	214
Power terminals	216
Other tools	218

Assembly tools

TCA products

Press-fit tool

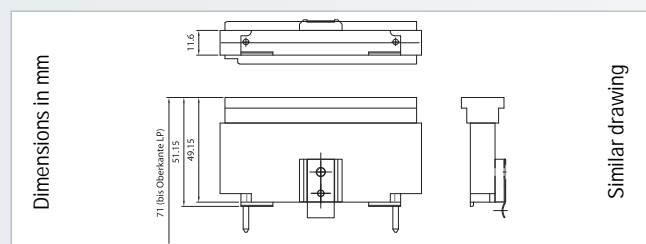

AdvancedTCA® Signal B+	
Type	Part number
AMC B+	886-115-W21

On request
– Customer-specific adaptation

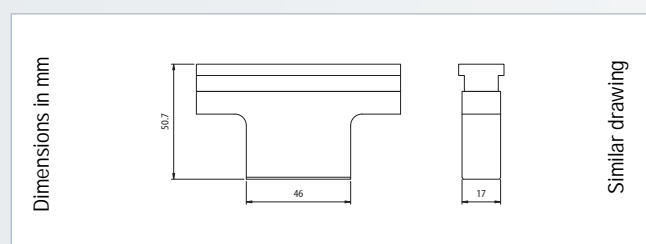

AdvancedTCA® Power male connector	
Type	Part number
Male connector	884-050-W1

On request
– Customer-specific adaptation

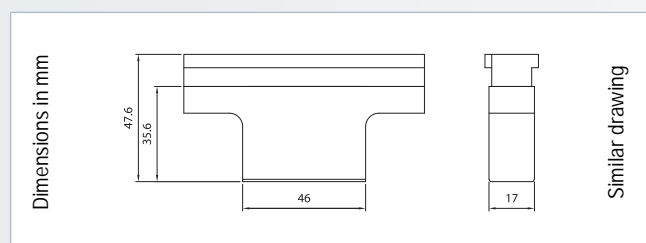

AdvancedTCA® Power female connector	
Type	Part number
Female connector	884-051-W1

On request
– Customer-specific adaptation

Dimensions in mm

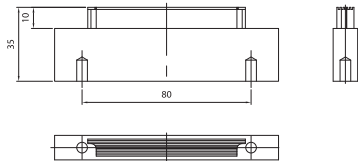

Similar drawing



Similar image

AdvancedTCA® Signal B+	
Type	Part number
AMC B+ with/without peg	890-115-W21

On request
– Customer-specific adaptation

Dimensions in mm

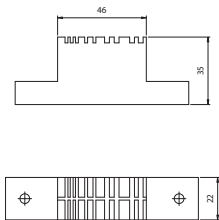

Similar drawing



Similar image

AdvancedTCA® Power male/female connector	
Type	Part number
Male connector	890-050-W1
Female connector	890-051-W1

On request
– Customer-specific adaptation

Assembly tools

TCA products

Press-fit tool

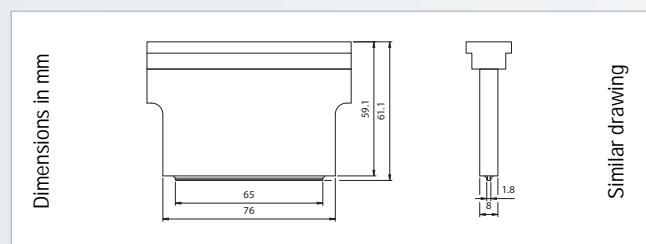

MicroTCA® Signal AMC	
Type	Part number
MicroTCA® AMC	884-046-W1

On request
– Customer-specific adaptation

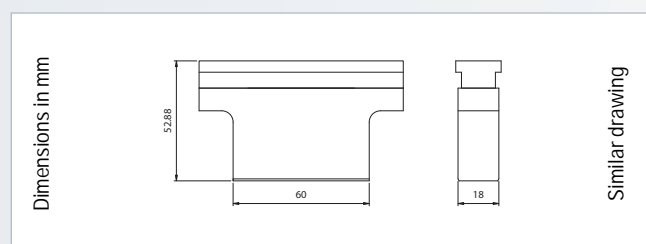

MicroTCA® Power	
Type	Part number
Power module output	884-045-W1

On request
– Customer-specific adaptation

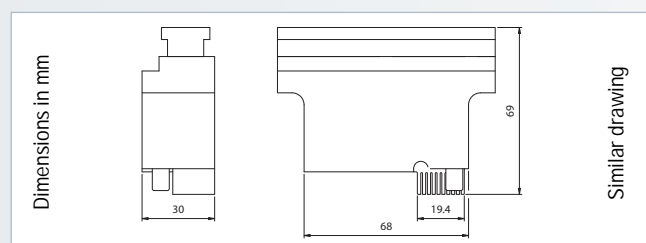

MicroTCA® Power	
Type	Part number
Backplane connector	884-044-W1

On request
– Customer-specific adaptation

Dimensions in mm

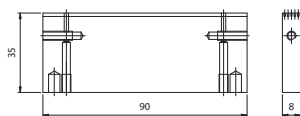

Similar drawing



Similar image

MicroTCA® Signal AMC

Type	Part number
MicroTCA® AMC	890-046-W1

On request

– Customer-specific adaptation

Dimensions in mm

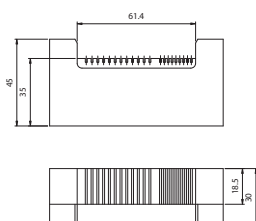

Similar drawing



Similar image

MicroTCA® Power

Type	Part number
Power module output	890-045-W1

On request

– Customer-specific adaptation

Dimensions in mm

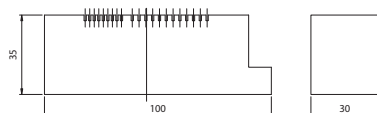

Similar drawing

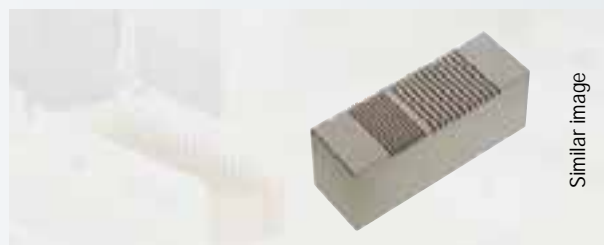

Similar image

MicroTCA® Power

Type	Part number
Backplane connector	890-044-W1

On request

– Customer-specific adaptation

Assembly tools

Hardmetric products

Press-fit tool

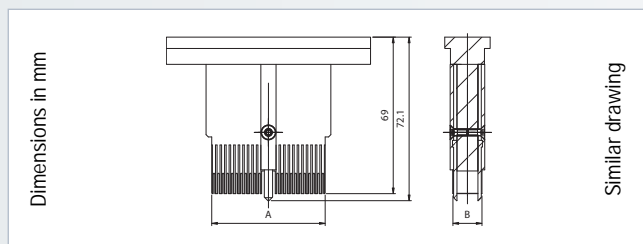

hm 2.0 male connector			
Type	Dimension A	Dimension B	Part number
A	50	13.6	884-700-W25
D	50	19.6	884-710-W25



On request
– Customer-specific adaptation

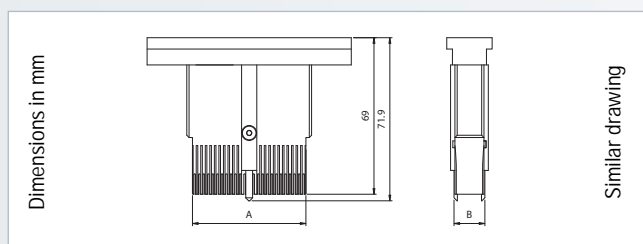

hm 2.0 male connector			
Type	Dimension A	Dimension B	Part number
AB25	50	13.6	884-708-W25
AB22	44	13.6	884-708-W22
AB19	38	13.6	884-708-W19
DE	50	19.6	884-712-W25



On request
– Customer-specific adaptation

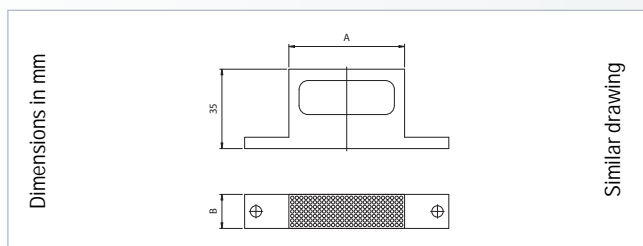

hm 2.0 male connector			
Type	Dimension A	Dimension B	Part number
A	51	15	890-700-W25
D	51	21	890-710-W25
AB25	51	15	890-701-W25
AB22	45	15	890-701-W22
AB19	39	15	890-701-W19
DE	51	21	890-711-W25

On request
 – Customer-specific adaptation

Assembly tools

Hardmetric products

Press-fit tool

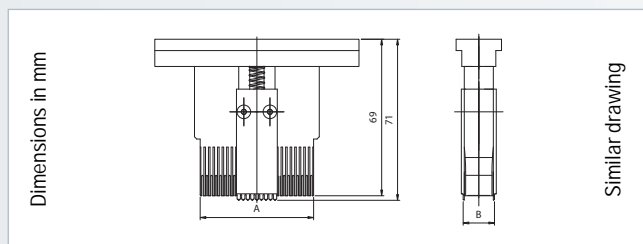

hm 2.0 male connector			
Type	Dimension A	Dimension B	Part number
B25	50	13.6	884-701-W25
B22	44	13.6	884-701-W22
B19	38	13.6	884-701-W19
E	50	19.6	884-711-W25

On request
– Customer-specific adaptation

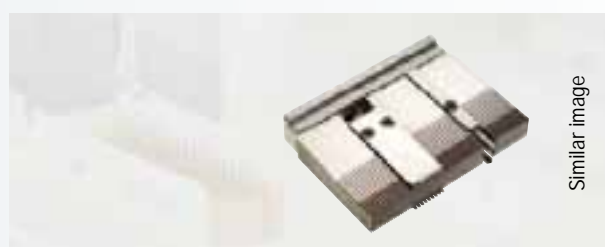
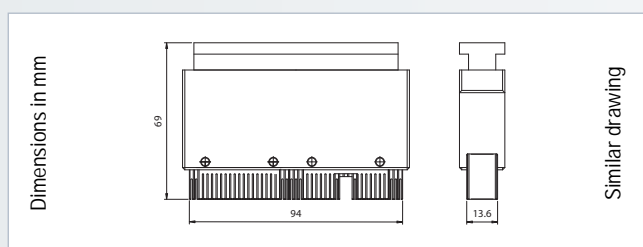

hm 2.0 accessory male connector	
Type	Part number
A + B22 (cPCI)	884-703-W47

On request
– Customer-specific adaptation

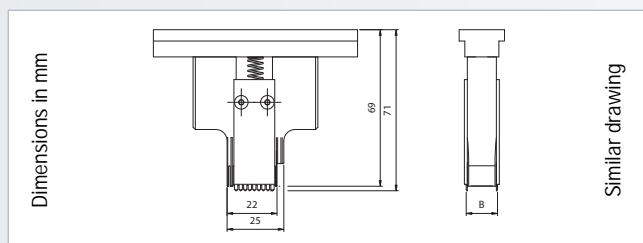

hm 2.0 male connector		
Type	Dimension B	Part number
C	13.6	884-702-W11
F	19.6	884-713-W11

On request
– Customer-specific adaptation

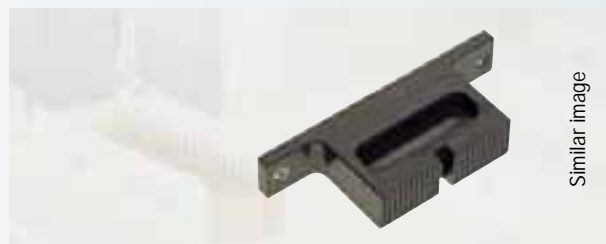
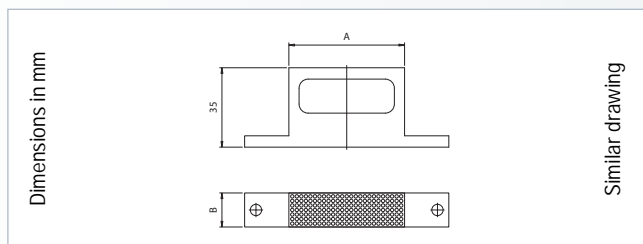

hm 2.0 male connector			
Type	Dimension A	Dimension B	Part number
B25	51	15	890-701-W25
B22	45	15	890-701-W22
B19	39	15	890-701-W19
E	51	21	890-711-W25
C	23	15	890-702-W11
F	23	21	890-713-W11
A + B22 (cPCI)	95	15	890-703-W47

On request
 – Customer-specific adaptation

Assembly tools

Hardmetric products

Press-fit tool

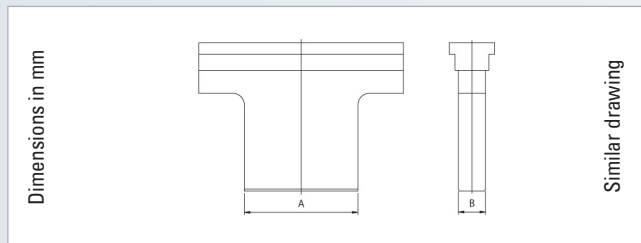

hm 2.0 female connector flat rock			
Type	Dimension A	Dimension B	Part number
A	50	12	884-720-W25
B25	50	12	884-720-W25
B22	44	12	884-720-W22
B19	38	12	884-720-W19
AB25	50	12	884-720-W25
AB22	44	12	884-720-W22
AB19	38	12	884-720-W19
C	25	12	884-720-W11
D	50	16	884-730-W25
E	50	16	884-730-W25
DE	50	16	884-730-W25
F	25	16	884-730-W11
A + B22 (cPCI)	94	12	884-720-W47

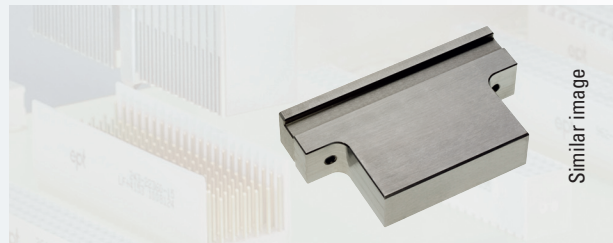

On request
– Customer-specific adaptation

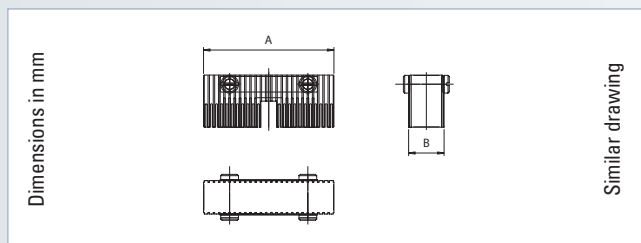

hm 2.0 male connector			
Type	Dimension A	Dimension B	Part number
A	50	13.6	884-700-W125
B	50	13.6	884-700-W125
B22	44	13.6	884-701-W122
B19	38	13.6	884-708-W119
AB25	50	13.6	884-708-W125
AB22	44	13.6	884-708-W122
AB19	38	13.6	884-708-W119
C	25	13.6	884-702-W111
D	50	19.6	884-710-W125
E	50	19.6	884-711-W125
DE	50	19.6	884-712-W125
F	25	19.6	884-713-W111
A + B22 (cPCI)	94	13.6	884-703-W147



On request
– Customer-specific adaptation

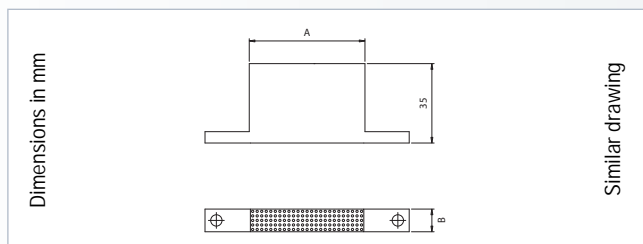

hm 2.0 female connector			
Type	Dimension A	Dimension B	Part number
A	50	10	890-720-W25
B25	50	10	890-720-W25
B22	44	10	890-720-W22
B19	38	10	890-720-W19
AB25	50	10	890-720-W25
AB22	44	10	890-720-W22
AB19	38	10	890-720-W19
C	25	10	890-720-W11
D	50	13	890-710-W25/1
E	50	13	890-711-W25/1
DE	50	13	890-731-W25
F	25	13	890-713-W11/1
A + B22 (cPCI)	94	10	890-720-W47

On request
 – Customer-specific adaptation

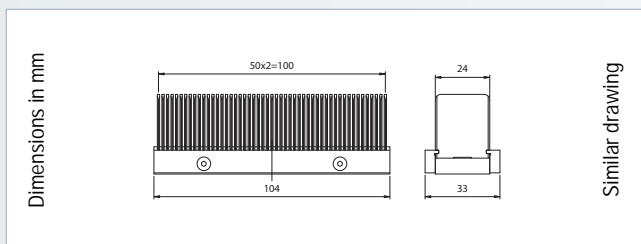

hm 2.0 support tool	
Type	Part number
Modular	890-705-W50

On request
 – Customer-specific adaptation

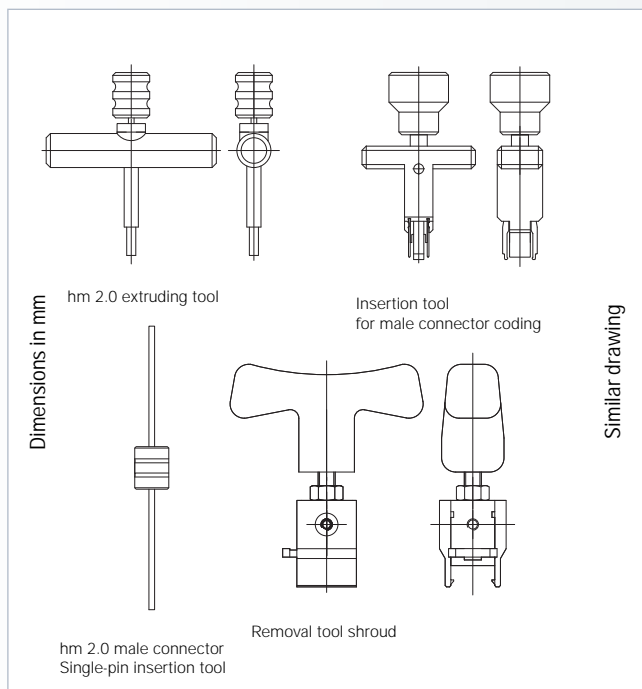

hm 2.0 repair kit	
Contents of the kit	Part number
A, B, C, D	892-705-W1
C, D	892-705-W2

On request
– Customer-specific adaptation



Removal tool/shroud



Insertion tool for male connector coding



hm 2.0 extruding tool



hm 2.0 male connector single-pin/insertion tool

Assembly tools

DIN products

Press-fit tool

Dimensions in mm

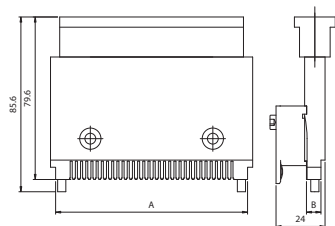

Similar drawing



Similar image

DIN male connector			
Type	Dimension A	Dimension B	Part number
B	94	5.5	884-150
B/2	53.4	5.5	884-151
B/3	38	5.5	884-152
C	94	8.5	884-250
C/2	53.4	8.5	884-251
C/3	38	8.5	884-252

On request
– Customer-specific adaptation

Dimensions in mm

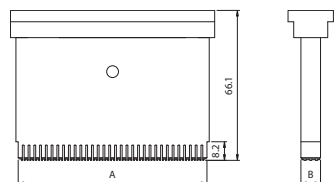

Similar drawing



Similar image

DIN male connector			
Type	Dimension A	Dimension B	Part number
R	83	8.6	884-525
R/2	42.5	8.6	884-526
R/3	27.3	8.6	884-527

On request
– Customer-specific adaptation

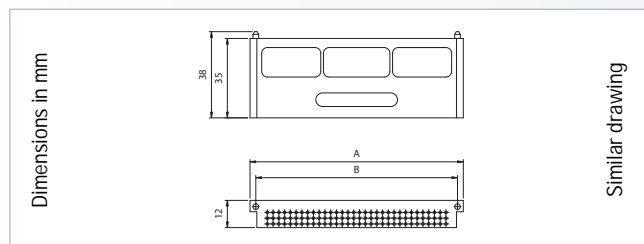

DIN male connector			
Type	Dimension A	Dimension B	Part number
B	96	89	890-302
B/2	55	48	890-303
B/3	40	33	890-304
C	96	89	890-305
C/2	55	48	890-306
C/3	40	33	890-307

On request

– Customer-specific adaptation

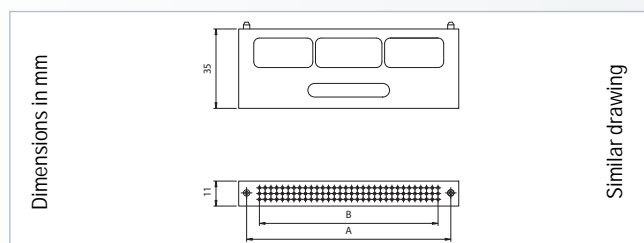

DIN male connector			
Type	Dimension A	Dimension B	Part number
R	90	78.74	890-317
R/2	50	38.10	890-348
R/3	34.76	22.86	890-336

On request

– Customer-specific adaptation

Assembly tools

DIN products

Press-fit tool

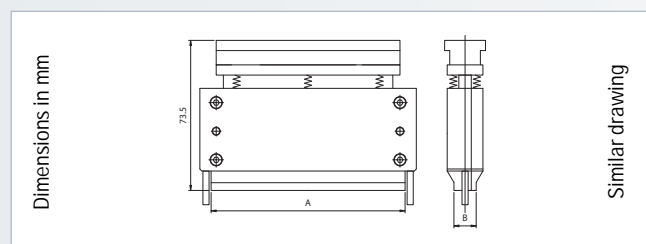

DIN female connector			
Type	Dimension A	Dimension B	Part number
B*	95	11	884-100
B/2*	54	11	884-101
B/3*	39	11	884-102
C**	95	13.5	884-200
C/2**	54	13.5	884-201
C/3**	39	13.5	884-202
D	95	13.5	884-303
E	95	18.6	884-353
F	95	17.5	884-401
F low profile	95	17.5	884-406
G	95	22.6	884-453
G low profile	95	22.6	884-451
VME switching connector	95	–	884-200
Switching connector across rows	95	–	888-214

On request

– Customer-specific adaptation

Note

* Only for connector 102-x

** Only for connector 104-x

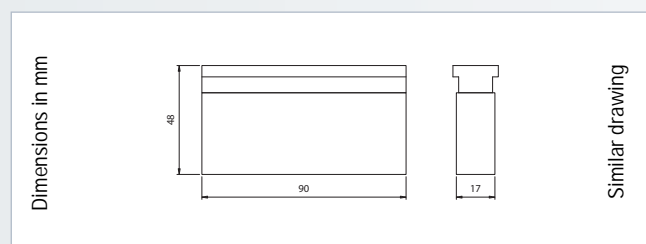

DIN female connector	
Type	Part number
B*	886-900-W1
C**	886-900-W1
C/2**	886-900-W1
C/3**	886-900-W1
VME 64x	886-900-W1

On request

– Customer-specific adaptation

Note

* Only for connector 302-x

** Only for connector 304-x

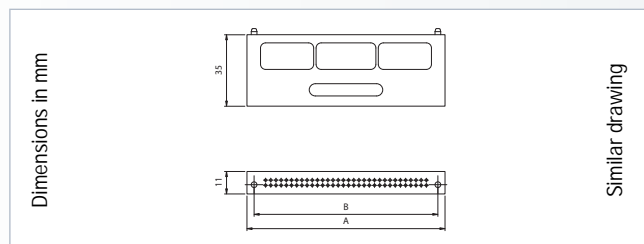

DIN female connector			
Type	Dimension A	Dimension B	Part number
B	97	90	890-333
B/2	57	49.36	890-334
B/3	40	34	890-335
C and switching connector	97	90	890-317
C/2	57	49.36	890-331
C/3	41	34	890-332

On request

– Customer-specific adaptation

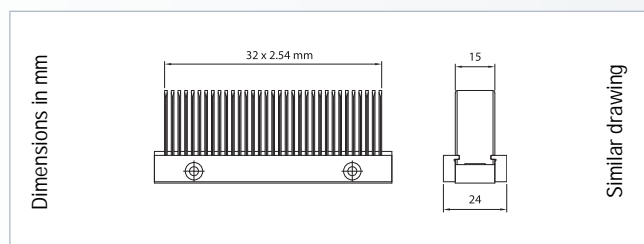

DIN female connector	
Type	Part number
D	890-100-W1
E	890-100-W1
F	890-100-W1
F low profile	890-100-W1
G	890-100-W1
G low profile	890-100-W1
VME 64x	890-100-W10

On request

– Customer-specific adaptation

Assembly tools

DIN products

Press-fit tool

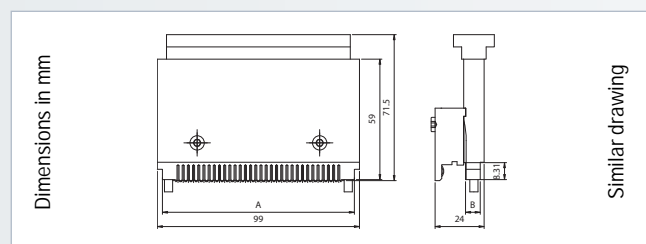

DIN female connector			
Type	Dimension A	Dimension B	Part number
R	94	7.2	884-500
R/2	55	7.2	884-501
R/3	–	7.2	890-504

On request
– Customer-specific adaptation

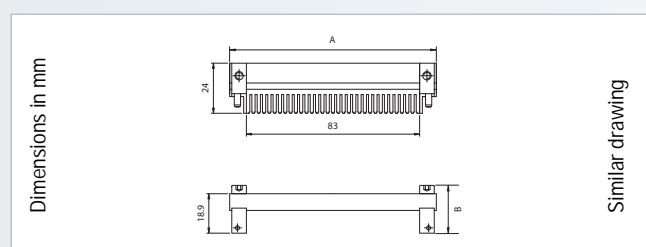

DIN male connector insert block for flat rock			
Type	Dimension A	Dimension B	Part number
C	99	13.6	884-260
C/2	59	13.6	884-261
C/3	41	13.6	884-262

On request
– Customer-specific adaptation

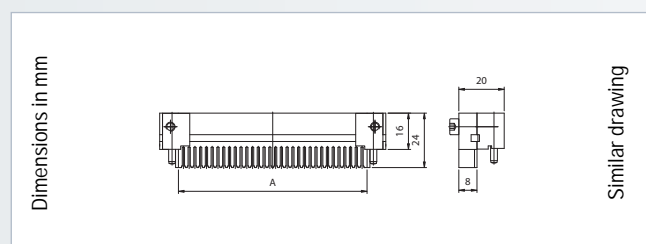

DIN female connector insert block for flat rock			
Type	Dimension A	Dimension B	Part number
R	83.13	8	884-503
R/2	42.49	8	884-502
R/3	27.40	8	884-504

On request
– Customer-specific adaptation

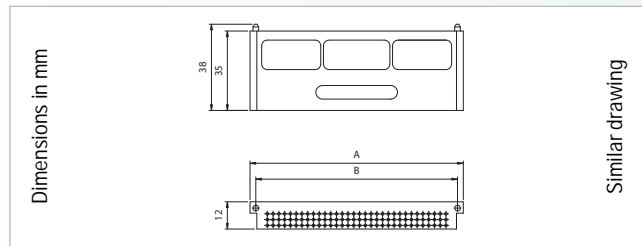

DIN female connector			
Type	Dimension A	Dimension B	Part number
R	96	89	890-305
R/2	55	48	890-306
R/3	40	33	890-307

On request
 – Customer-specific adaptation

Assembly tools

Accessories

Dimensions in mm

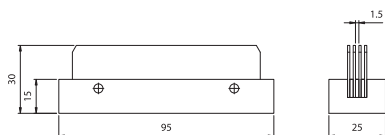

Similar drawing



Similar image

DIN disassembly support tool

Type	Part number
B/C female connector	892-300
R male connector	892-304
D female connector	892-301
F low profile female connector	892-302
E female connector	892-303

On request
– Customer-specific adaptation

Dimensions in mm

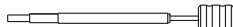

Similar drawing



Similar image

DIN extruding tool single contacts male connector

Type	Part number
0.6 x 0.6	892-203

On request
– Customer-specific adaptation

Dimensions in mm

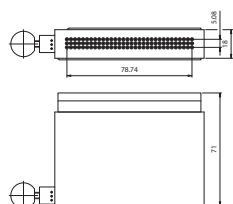

Similar drawing



Similar image

DIN extruding tool contacts male and female connector

Type	Part number
Short contacts	892-210
B/C female connector, R male connector	892-200
D/E female connector	892-201
F low profile female connector	892-202

On request
– Customer-specific adaptation

Dimensions in mm

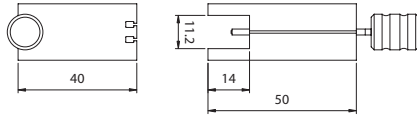

Similar drawing

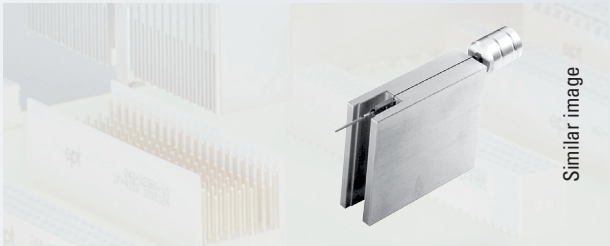

Similar image

DIN insertion tool single contacts female connector

Type	Part number
B*	892-400
C**	892-401
R	892-405
D	892-402
E	892-403
F low profile	892-404

On request

– Customer-specific adaptation

Note

* Only for connector 102-x

** Only for connector 304-x

Dimensions in mm

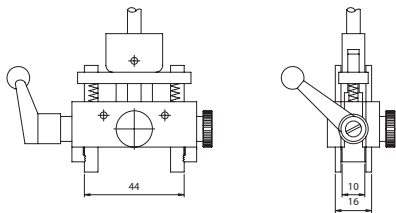

Similar drawing

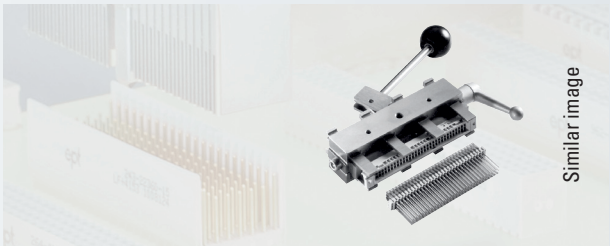

Similar image

DIN female connector ejector tool

Type	Part number
1/1	892-100
1/2	892-103
1/3	892-104

On request

– Customer-specific adaptation

Dimensions in mm

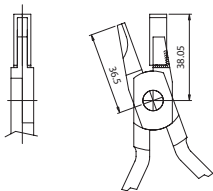

Similar drawing



Similar image

DIN keying pliers

Type	Part number
B and C	894-301

On request

– Customer-specific adaptation

Assembly tools

PC/104, PC/104-Plus, VarPol connector

Press-fit tool

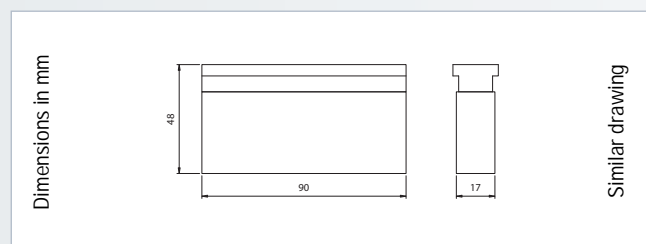

PC/104, PC/104-Plus, VarPol female connector	
Type	Part number
PC 104	886-900-W1
PC/104-Plus	886-900-W3
PC/104-Plus in 22 mm	886-900-W5
VarPol 1-, 2-row	886-900

On request
– Customer-specific adaptation

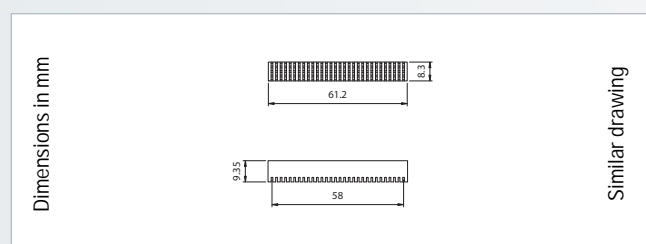

PC/104-Plus straight pin header	
Type	Part number
2 mm grid	886-903-W1

On request
– Customer-specific adaptation

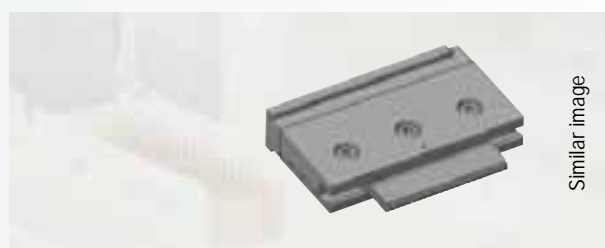
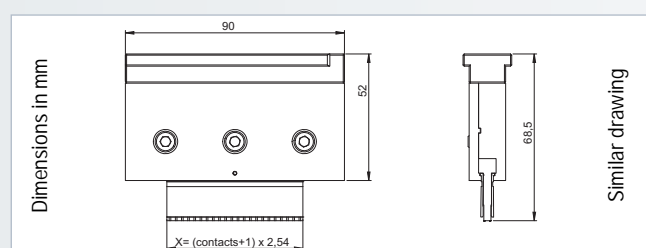

VarPol pin header	
Type	Part number
Straight, 1-row	886-461-xx
Straight, 2-row	886-474-xx
Straight, 3-row	886-463-xx
Angled, 1-row	886-471-xx
Angled, 2-row	886-472-xx
Angled, 3-row	886-473-xx

On request
– Customer-specific adaptation
– flat rock insert 2-row: 886-466-xx
 3-row: 886-467-xx

Note
xx = no. of contacts of connector per row

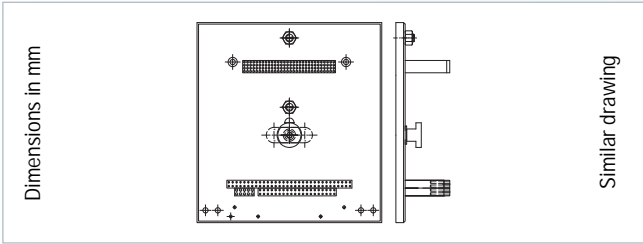

PC/104, PC/104-Plus female connector	
Type	Part number
PC/104	890-600-W1
PC/104-Plus	890-602-W1

On request

– Customer-specific adaptation

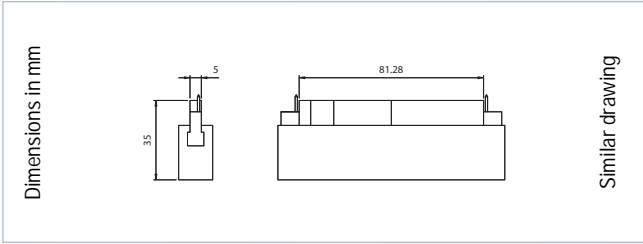

VarPol female connector and VarPol pin header	
Type	Part number
1-row	890-330-xx
2-row	890-323-xx

On request

– Customer-specific adaptation

Note

xx = no. of contacts of connector per row

Assembly tools

Power terminals

Press-fit tool

Dimensions in mm

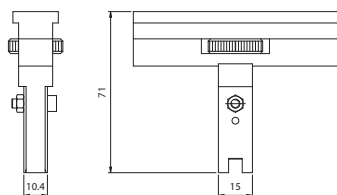

Similar drawing



Similar image

Power terminal	
Type	Part number
Grid 5.08 x 7.62	
Part No. 910-2xxxx	886-601
Part No. 910-6xxxx	886-601
Grid 5.08 x 10.16	
Part No. 911-320xx	886-601-1
Part No. 911-330xx	886-601-1
Part No. 911-322xx	886-604
Part No. 911-322xx	886-604

On request
– Customer-specific adaptation

Dimensions in mm

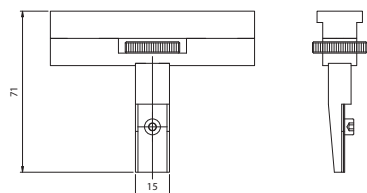

Similar drawing



Similar image

Blade connector	
Type	Part number
Blade connector	884-650

On request
– Customer-specific adaptation

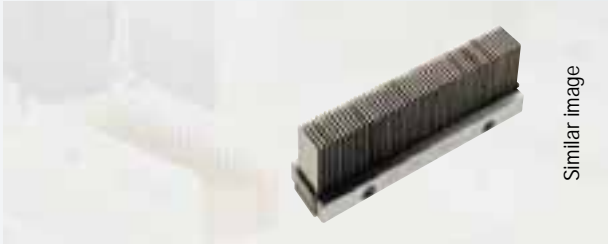
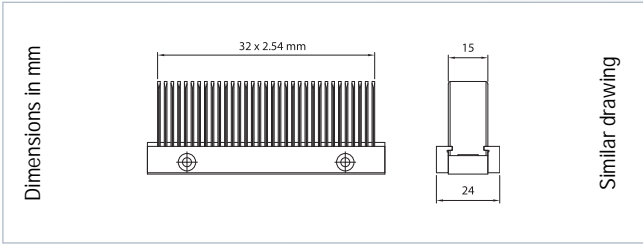

Universal support tool grid 2.54 mm	
Type	Part number
Modular	890-100-W1

On request
– Customer-specific adaptation

Assembly tools

Other tool

Dimensions in mm

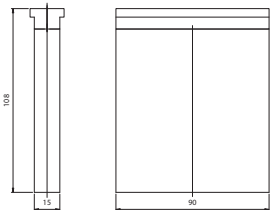

Similar drawing

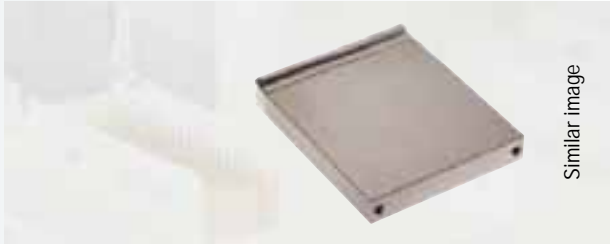

Alignment tool	
Type	Part number
Alignment tool	892-903

On request

– Customer-specific adaptation

Dimensions in mm

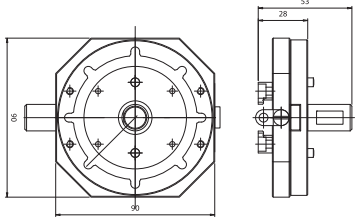

Similar drawing



Rotary tool holder	
Type	Part number
Rotary tool holder	882-204-W1

On request

– Customer-specific adaptation

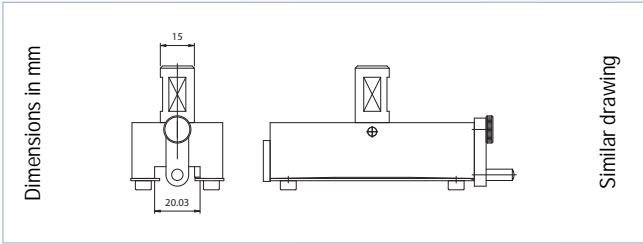

Quick release tool holder	
Type	Part number
Quick release tool holder	882-201



On request
– Customer-specific adaptation

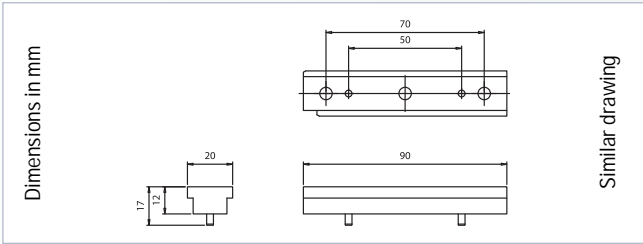

Tool adapter	
Type	Part number
T-unit	882-300



On request
– Customer-specific adaptation